

IMPORTANT CONSUMER INFORMATION — DO NOT THROW AWAY!

Limited Lifetime Warranty

(EFFECTIVE DATE 4/23/03)

United States Marble, Inc. ("US Marble") Engineered Marble, Granite, & Onyx products are warranted to the original purchaser to be free from manufacturing defects. United States Marble will, at its option, replace, repair, or make suitable adjustment, where our inspection shows any such defects occurring in normal use, in a residential application, to the original owner/purchaser. Normal wear and tear excluded. Commercial applications excluded. Bathtub warranty limited to 5 years; whirlpool hardware, if any, limited to the warranty of the original equipment manufacturer. Contact US Marble for further details. US Marble is not responsible for any removal, installation or labor cost, or any consequential damages as a result of any defective product. Improper installation, care or maintenance of the product, or water temperature exceeding 150°F (+/- 3°F), will void this warranty. Implied warranties, including that of merchantability, are expressly limited in duration to the expiration of the warranty. This warranty gives you specific legal rights. You may also have other rights which vary from state to state. This is our exclusive written warranty. Warranty Registration Card must be submitted within 60 days of the Original Purchaser's receipt of the product to validate this warranty. To obtain warranty service you must have your original sales receipt. You may contact the place of purchase to initiate, or contact US Marble at 7839 Costabella Ave, Remus, MI 49340.

NOTE:

Dimensions are nominal. Delivered product may vary $\pm 1/4"$.

NOT COVERED BY WARRANTY:

- US Marble does not replace product on the basis of color hues, veining patterns, or intensity. Store samples are a representation of the final product – and can vary in shading and veining. Website and/or brochure color illustrations should be used as a reference only. Customers should make their final color selections from actual store samples. Gloss finish is standard. Optional matte finish tones down the color. When matted, darker colors may look dramatically different than the gloss finish.
- US Marble does not replace product resulting from damages occurring after delivery; during installation or storage of the product; improper storage/handling; water temperatures in excess of 150°; use of abrasive or improper cleaners or chemicals; repair by someone other than US Marble factory-trained representatives.

060109

Check our website
for more information.



www.usmarble.com

Maintenance & Cleaning

Gloss Finish (Standard):

Cleaning with a soft sponge or cloth, and a nonabrasive soap or foam cleaner is all that is required to keep your product looking beautiful for years. An automotive buffing compound may be used for any minor scratches. Any lime, rust or calcium deposits may be removed with cleaners made for that purpose. WE RECOMMEND GEL-GLOSS AS A ONE-STEP CLEANER AND POLISHER.

Matte Finish (Optional):

Clean with detergent or household cleaner. Minor scratches, shiny spots and even cigarette burns can be removed with a Scotch-Brite pad, such as 3M #7447. (Piece Included)



PRODUCT CERTIFICATION: U.S. Marble is committed to quality. Our manufactured product is made in the U.S.A. Our products are certified to conform to HUD/UM 73a, Ansi Z34.1, Z124.3, ICPA, through a program of factory inspection by Elite Global Testing.



US Marble

A CLIO HOLDINGS COMPANY
7839 Costabella Ave, Remus, MI 49340
Phone: 989-561-2293 • Fax: 989-561-2997
www.usmarble.com

Installation — Easy as 1-2-3!

BEFORE INSTALLATION: Advise U.S. Marble if you feel there is a problem. Warranty states: "United States Marble is not responsible for any removal, installation, or labor cost, or any consequential damages as a result of any defective product."

What you will need:

- Paintable Silicone Sealant
- Level and Square
- Caulking Gun (depending on your sealant packaging)
- Faucet & Supply Lines (standard hole size and spacing)
- Adjustable Wrench or Basic Wrench

Step 1:

- Shim vanity unit level
- Check that bathroom vanity is secure to the wall
- Trial fit vanity top onto vanity to ensure correct size and level fit.

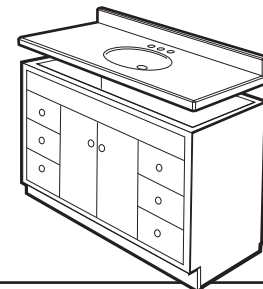

Step 2:

- Remove vanity top
- Install faucet & supply lines
- Tighten drain nut until finger tight plus 1/4 turn.

Do not over-tighten!

Over-tightening can eventually result in cracks in the bowl.

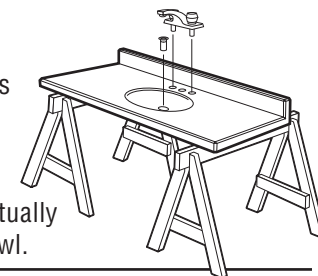

Step 3:

- Place a bead of paintable silicone sealant on top edge of each corner of vanity.
- Carefully place vanity top on vanity and press firmly into place.
- Wipe away excess sealant.
- Let sealant set until dry.

